

WARNING!
PRESSURE IN THE PERMEATE PORT SHALL NOT EXCEED
125PSI (0.86Mpa)

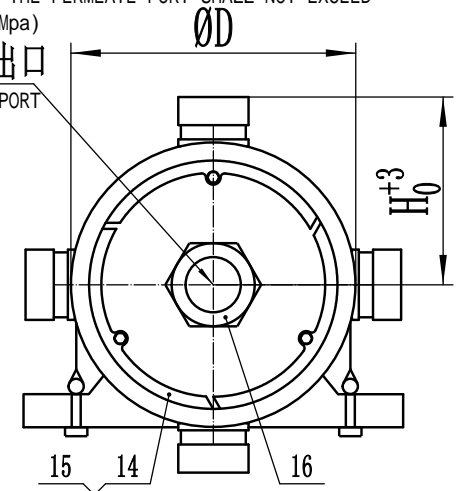

PERMEATE PORT OPTION:
1" NPT FEMALE THREAD
1" G FEMAL THREAD
1" SANITARY CONNECTION

- 设计压力2.1MPa(300PSI)
Design Pressure 2.1MPa(300PSI)
- 设计温度66°C (150° F)
Design Temperature 66°C (150° F)
- 最低允许温度-10°C (14° F)
Min Temperature -10°C (14° F)
- 工作介质为PH3-10的水
Media:Water PH3-10
- 净水口压力为0.88MPa (125PSI)
0.88MPa (125PSI)
- 项目3数量由客户选择决定; 项目5仅在浓水端
Media:Water PH3-10
- 图纸仅供参考, 具体以实物为准
Drawings are for reference only, in kind
- 请按照说明书正确使用
Please operate it according to operation manual

长度编码 Length	S (mm)	L (mm)	P (mm)	重量 WEIGHT (kg)
1	534 (21)	1446 (56.9)	1147 (45.2)	30 (66)
2	1550 (61)	2462 (96.9)	2136 (85.2)	42 (92.4)
3	2566 (101)	3478 (136.9)	3152 (125.2)	54 (118.8)
4	3582 (141)	4494 (176.9)	4168 (165.2)	66 (145.2)
5	4598 (181)	5510 (216.9)	5184 (205.2)	78 (171.6)
6	5614 (221)	6526 (256.9)	6200 (245.2)	90 (198)
7	6630 (261)	7542 (296.9)	7216 (285.2)	102 (224.4)

16	紧固螺母 FASTENING NUT	2	工程塑料Engineering Plastic
14/15	挡块+挡块螺丝 LINK STOPPER+BAFFLE FIXING BOLTS	6	SUS304
12/13	钢带STRAP+螺丝screwhead	2-3	A-666, 304+SUS304
11	鞍座SADDLE	2-3	TPU(S60D)
10	密封板 SEALBOARD	2	ABS
09	适配器ADAPTOR	2	ABS
08	适配器O型圈ADAPTOR O RING	4	EPDM 512
07	O型圈 O RING	4	EPDM 512
06	承载板BEARING PLATE	1	SB-209, 6061-T651
05	止推环THRUST CONE	1	工程塑料Engineering Plastic
04	侧口两圈 SIDE DORT	2	SUS304
03	侧口SIDE PORT	2	SUS304
02	侧口密封圈SIDE PORT SEAL RING	4	EPDM 512
01	壳体SHELL	1	FIBER GLASS +EPOXY
	名称	数量	材料

原浓水口规格	D	H
1. 5" (DN40)	245	150
2" (DN50)	245	150
2. 5" (DN65)	255	155

SIGNATURE		
NAME	DATE	
DESIGN	陈勇	2019.1.31
THIS DRAWING CAN NOT BE USED WITHOUT PRIOR WRITTEN APPROVAL OF OUR COMPANY		

河北成达华膜科技有限公司 HEBEI CHENGDA HUAMO TECHNOLOGY CO.,LTD.	
型号 TYPE	单位UNIT:
W80S450	MM
仅供参考, 零部件以图纸为准, 变更不另行通知	