

# WS 80S HIGH PRESSURE SERIES

## 8 INCH SIDE ENTRY MEMBRANE HOUSING-1200P

# MEMBRANE HOUSING DATASHEET

WS 80S1200

## General information

Winder W80S Series is membrane housing of 8" diameter with side entry. This is used for commercial, municipal and industrial RO applications. Vessel models are available up to a maximum operating pressure of 150 PSI, 300 PSI, 450 PSI, 600 PSI, 1000 PSI & 1200 PSI with multi-ports connectivity. These are made up of epoxy / glass composite to meet the demands of long term and continuous use in RO processes. Winder W80S Series vessels can accommodate any standard 8" membrane element.

Standard element length = 40"  
long

## CERTIFICATION:

- W80S coded: ASME code compliant, NSF certified



## Winder® W80S HIGH PRESSURE SERIES SPECIFICATION\*

## Code Compliant

## HIGHER TECHNOLOGY, CLEANER WATER!

MODEL	MAX OPERATION PRESSURE	MAX OPERATION TEMPERATURE	QUALIFICATION PRESSURE	ELEMENT LENGTH
W80S1000	1000 PSI/68Bar	150°F / 66 °C	6000PSI/413 Bar	1-8
W80S1200	1200 PSI/82Bar	150°F / 66 °C	7200PSI/496 Bar	1-8

## Winder® - W80S SERIES

### 8 INCH SIDE ENTRY MEMBRANE HOUSING-1200P

#### MEMBRANE HOUSING DATASHEET

##### UNIQUE BENEFITS

- Integrally Wound Locking Groove: Integrally wound locking groove gives enhanced end margin strength for better performance
- Flexibility in permeate piping: Standard permeate ports can be customized, NPT, BSPP, UNION, etc.
- Reduced system cost: Availability of Multiple Side port options for high flow rate cuts down the investments on expensive manifolds
- Ultrapure / Sanitary Applications: W80S Serie can accommodate optionally a special designed sanitary connection for the coded models

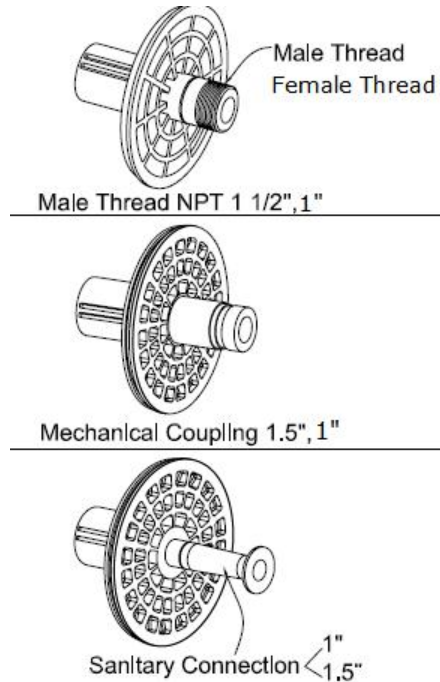

##### UNITUE FEATURES

- Mirror Finish ID for easy & quick loading and unloading of membranes
- Multi-ports options available with 1.5", 2.0", 2.5"&3" diameter for connecting vessels to each other
- Quick lock head retention system for quick access to membranes
- Exteriors coated with high gloss paint for UV resistance
- Head seal is captured, hence doesn't roll during head assembly fitment
- Compatible for using in all water type application
- Available in ASME certified & CE marked models
- Available in ASME code compliant and non-coded models

#### Winder® W80S SERIES

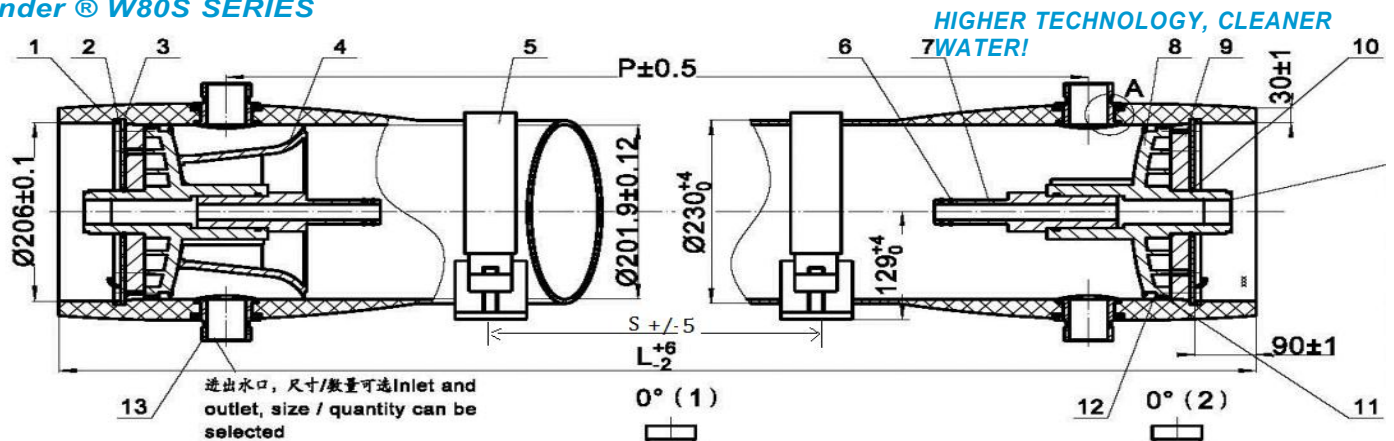

	L(mm)	P(mm)	S(mm)	CONCENTRATE PORTS OPTIONS
W80S1200-1	1623	1194	580	1.5", 2", 2.5", 3"
W80S1200-2	2639	2210	1350	
W80S1200-3	3655	3226	2080	
W80S1200-4	4671	4242	1600*2	
W80S1200-5	5687	5258	2000*2	
W80S1200-6	6703	6274	2360*2	
W80S1200-7	7719	7290	2860*2	

# Winder® - W80S SERIES

## 8 INCH SIDE ENTRY MEMBRANE HOUSING-1200P

## MEMBRANE HOUSING DATASHEET

## EXPLODED VIEW&DETAILS(CODED MODELS)-GENERAL VIEW FOR VISUAL REFERENCE

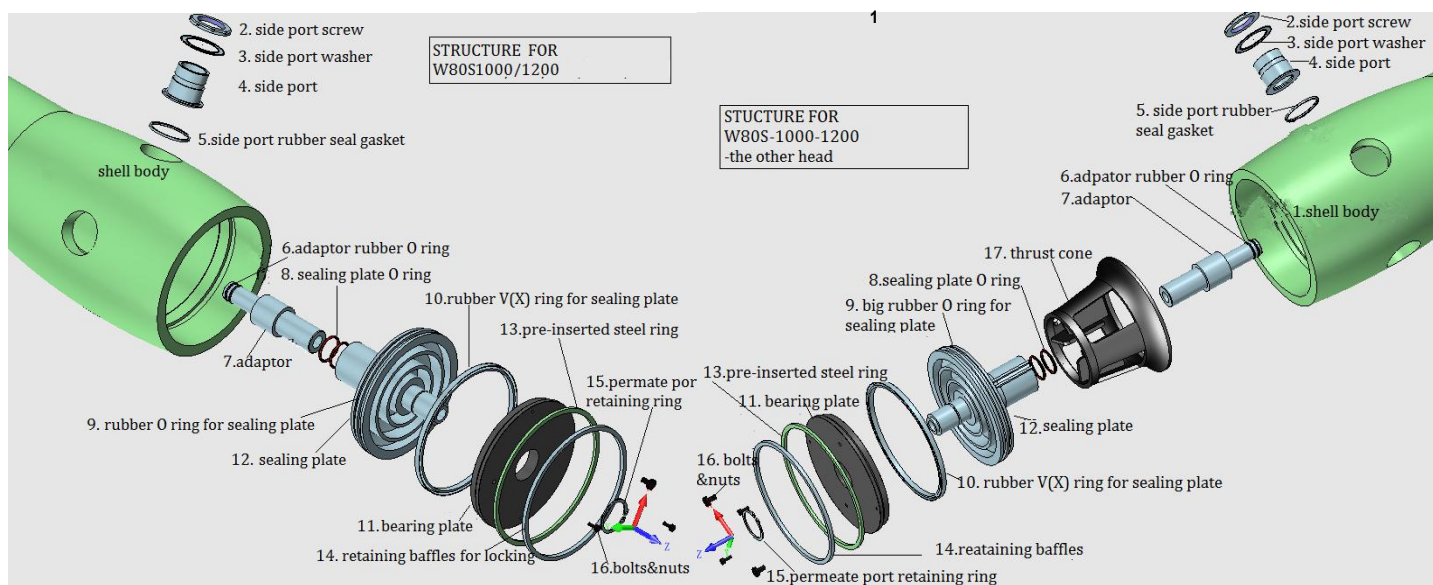

No.	QTY	DESCRIPTION	MATERIAL
1	1	Shell	Filament Wound Epoxy /Glass composites. Head Locking grooves integrally wound.
2	2	Side Port Screw	Stainless Steel
3	2	Side Port Washer	Stainless Steel
4	AR	F / C Port	Duplex Stainless Steel SS2205
5	AR	F / C Port Seal Gasket	EPDM
6	2	Adapter Seal	EPDM- o Ring
7	2	Adapter	Engineering Thermoplastic
8	2	Sealing Plate O Ring	EPDM - o Ring
9	2	Rubber O ring for sealing plate	EPDM - o Ring
10	2	Rubber V(X) Ring for Sealing Plate	EPDM -X(V) Ring
11	2	Bearing Plate	6061-T6 Aluminum Alloy - Hard Anodized
12	2	Sealing Plate	Engineering Thermoplastic
13	2	Preinserted Steel Ring	Stainless Steel
14	2	Retaing Baffles for Locking	SUS316
15	2	Permeate Port Retaining Ring	PVC
16	4	Bolts and nuts	Stainless Steel
17	1	Thrust Cone	Engineering Thermoplastic
15*	AR	Saddle	Engineering Thermoplastic
16*	AR	Strap Assembly	304 Stainless Steel - PVC Cushion
17*	AR	Strap Screw	Stainless Steel
18	AR	Positioning Ring	PVC

**HIGHER TECHNOLOGY. CLEANER WATER!**